

Arranging Multiple Displays/Monitors

Windows provides support for multiple displays (monitors). Windows will work with all connected monitors, but the monitors must be arranged through the Display Settings menu for the mouse and applications to work as expected.

Rearranging monitors on Windows

To rearrange monitors on Windows, follow these steps:

1. Right-click anywhere on your desktop and select **Display Settings**.

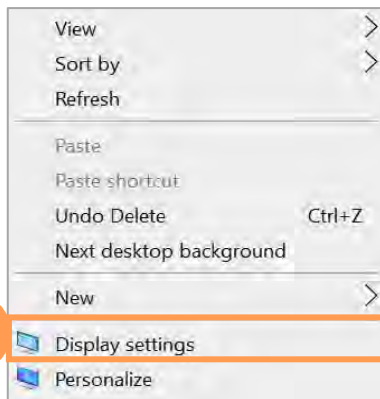

Note: You may need to maximize the window that opens to see all options.

2. Click the **Identify** button to have the identification number of the displays appear on the actual screens.
3. Under the **Select and rearrange displays** section, drag and drop each display to rearrange the displays according to their physical layout on your desk.

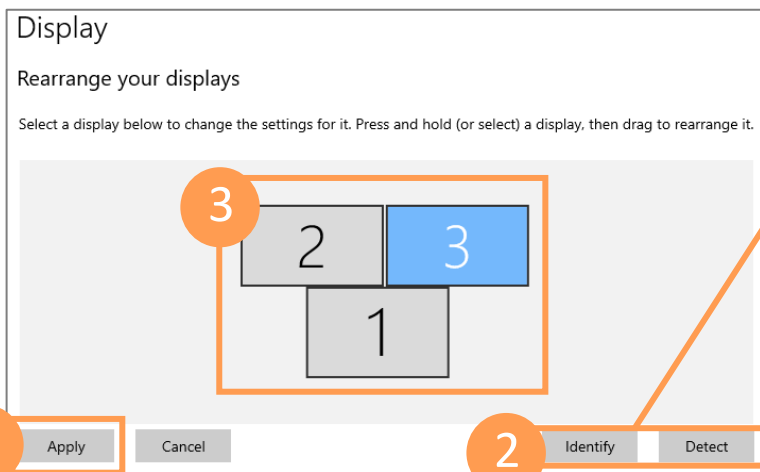

- Remember, if you're unsure which monitor you're selecting, click the **Identify** button to figure it out.
- **If a monitor isn't showing up, make sure it is receiving power and connected correctly, and then click the Detect button.**
- If you are still having problems, reset their connections (or restart the computer), and try the Detect button again.

Note: When rearranging monitors in the "Display" settings page, make sure that all monitors align at the top perfectly. Otherwise, you'll have problems moving the mouse cursor between monitors from the corners.

4. Click **Apply** to save your changes.

Once you complete the steps, Windows will save the physical layout, and you'll be able to work across each display and run applications without issues.